

Advanced Reel assembly instructions

for Above Ground Pools and Frame Pools

1

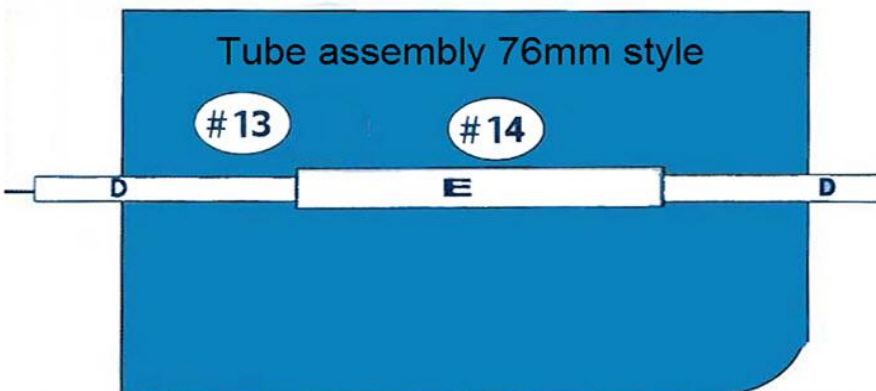
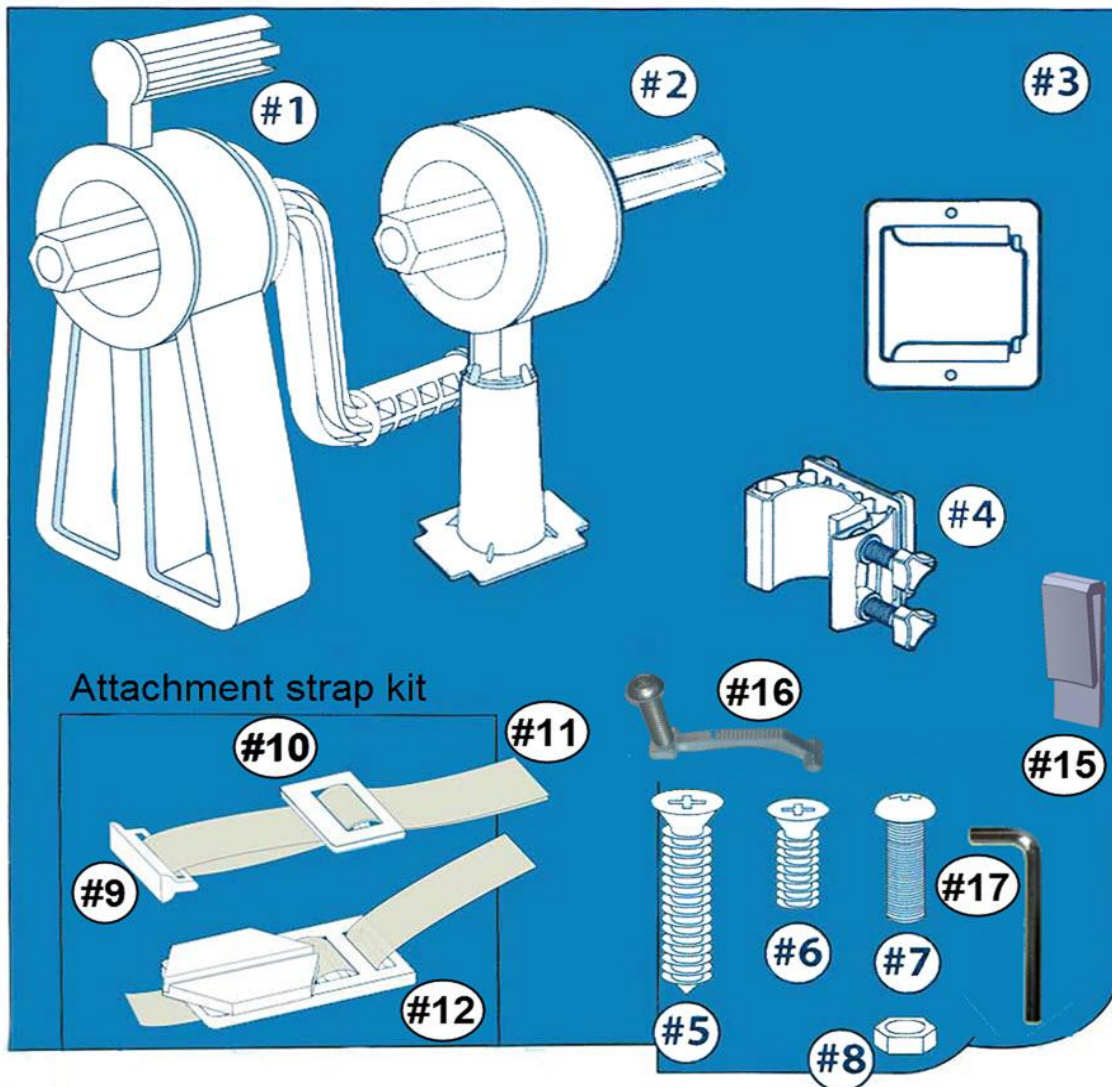

Item	Description	Qty
#1	Handle End	1
#2	Pivot End	1
#3	End mount plates	2
#4	Frame plates (optional)	2
#5	Handle & Tube screws	4
#6	Plate screws	8
#7	Plate bolts	8
#8	Plate Nuts	8
#9	Strap tube connectors	10
#10	Strap buckles	10
#11	Strap sets 1600mm	10
#12	Cover attachments	10
#13	Inner tubes	2
#14	Outer tube	1
#15	Tube clips	8
#16	Tube Locking pins	2
#17	Allen key	1

Hydrotools Pty Ltd

ACN 107 829 603 ABN 45 107 829 603

56 Magnesium Drive Crestmead, Queensland, 4132 Australia

www.hydrotools.com.au

sales@hydrotools.com.au

2

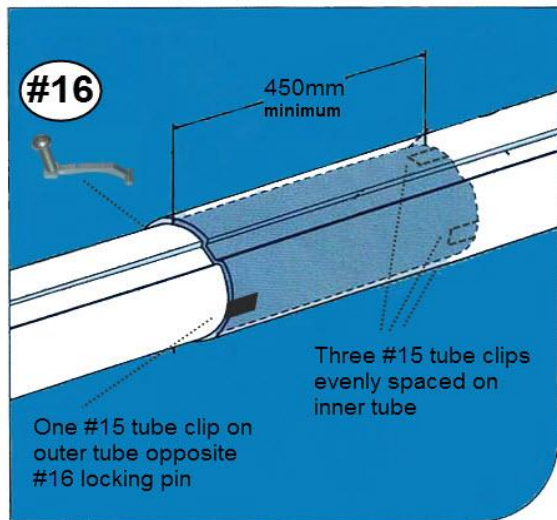

Evenly space three #15 tube clips around end (without drilled hole) of each Inner tube D. Slide the inner tube D into outer tube E and adjust the width to suit the pool. Insert locking pin #16 into the keyway on each inner tube D. Slide one #15 clip over outer tube opposite locking pin. Insert #9 strap connectors into the tube keyway on all tubes and space evenly between 600mm and 900mm apart.

3

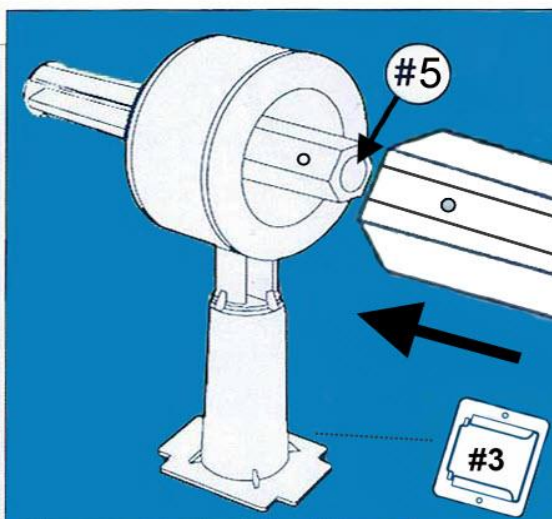
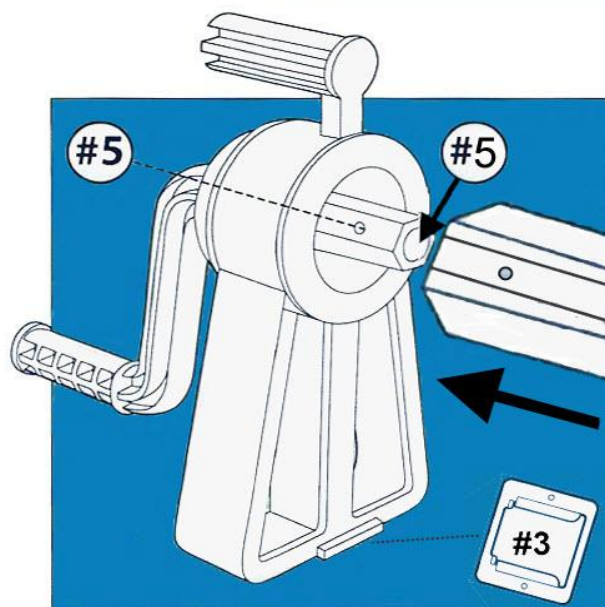

Attach #1 crank handle and #2 pivot end handle using the #6 screw inside the hex axle.

Insert the inner tube D into each end by aligning the tube hole with the hole in the plastic shaft. Secure with #5 screw.

Slide the #3 base plates onto the under side of each end support ready to be positioned on the pool coping.

4

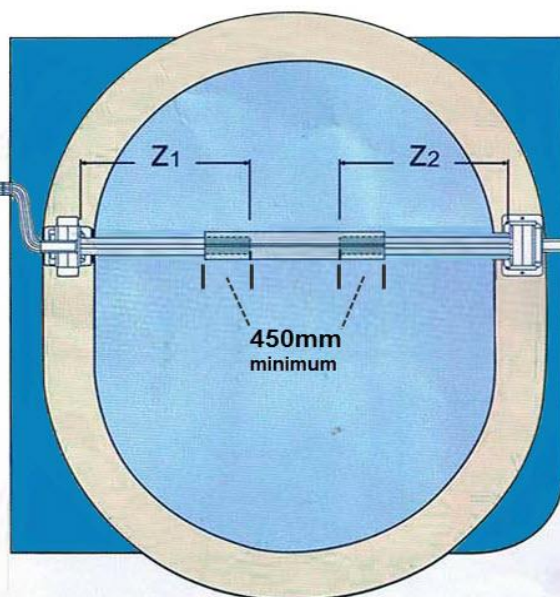
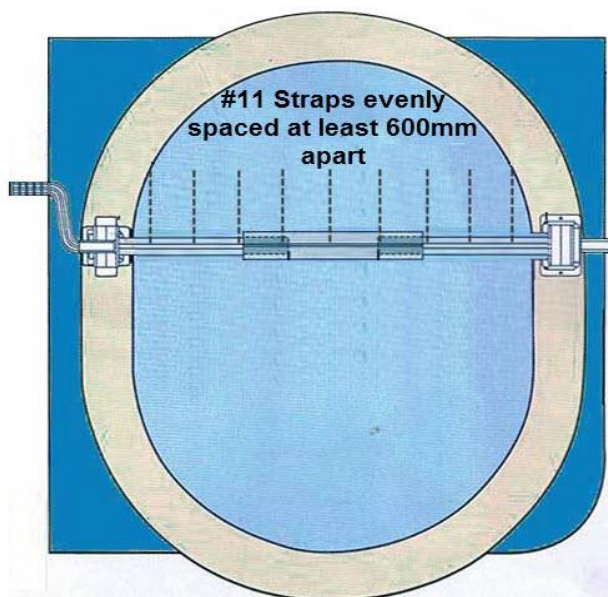

Place the Reel across the pool and adjust the width of the tubes making sure the length of each inner tube Z1 & Z2 is the same and then secure with the #16 locking pin and tighten with #17 Allen key.

For Round pools the Reel will sit in the centre.

For Oval pools, it will sit at the widest point at one end.

For Teardrop and Keyhole shape pools it will sit at the widest point. For Rectangular pools it will sit at the widest point close to one end.

Fasten #5 base plates to the top deck of the pool

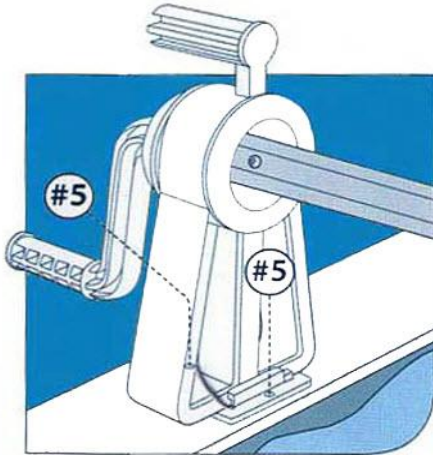

Using the #5 screws or the #7 plate bolts and #8 plate nuts, fasten the base plates to the top deck of the pool

The plates need to be secured to hold the weight and movement of the reel when rolling the pool cover, so please make sure they are adequately fastened to ensure they do not come loose over time.

If the pool is a frame style, see below for optional frame clamps.

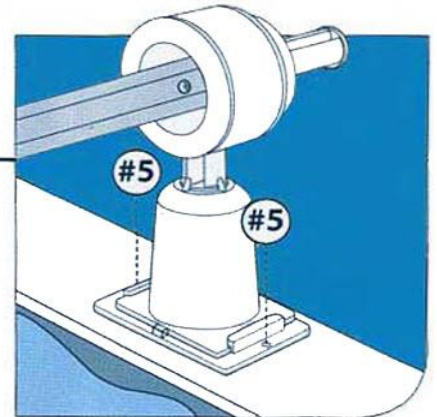

*Optional clamps for fitting to portable frame style pools

*There are optional clamps available for fitting the Reel to frame style pools.

The maximum outside frame width the clamps will fit is 60mm and they are designed to fit a round shape frame.

These clamps are an optional extra and are purchased separately and not included with the standard kit - request code **HRA60CL** (2 pieces)

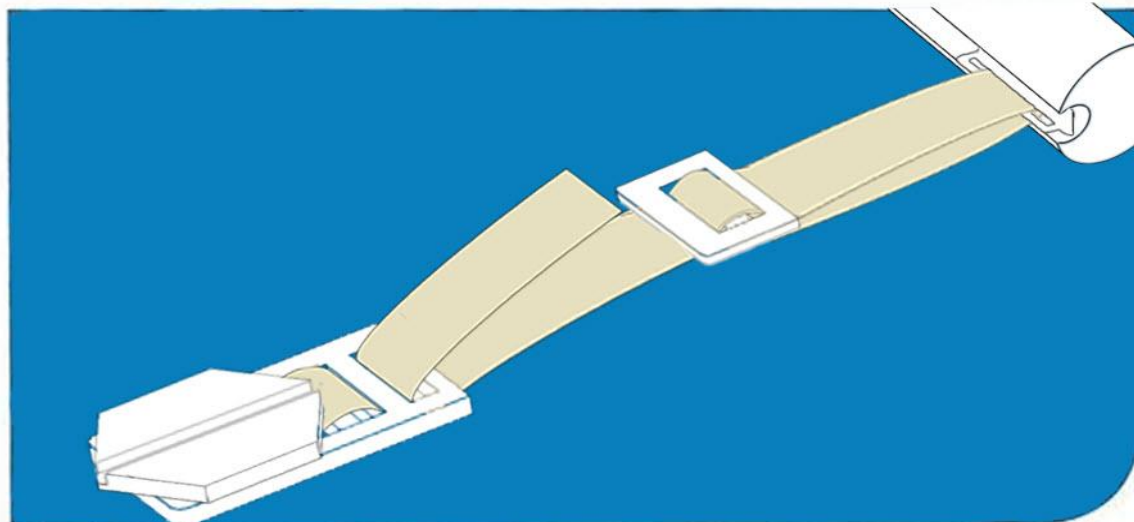
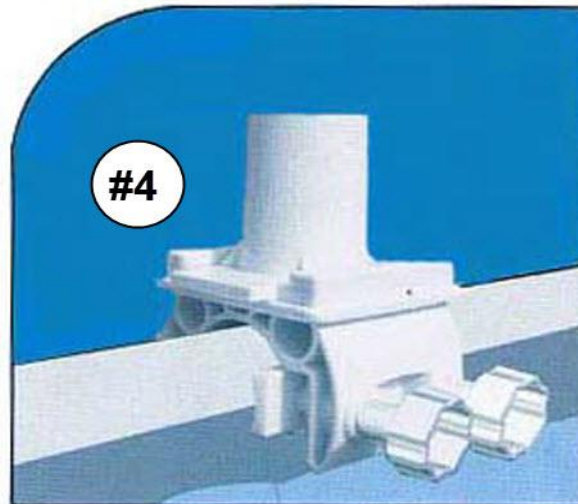

The #11 straps fasten through the pool cover using the screw provided with the #12 cover attachment.

Make sure the #11 straps are evenly spaced before you begin securing them to the pool cover.

You adjust the position of the strap by sliding it sideways through the tube keyway.

How to attach the straps at the end of a pool cover

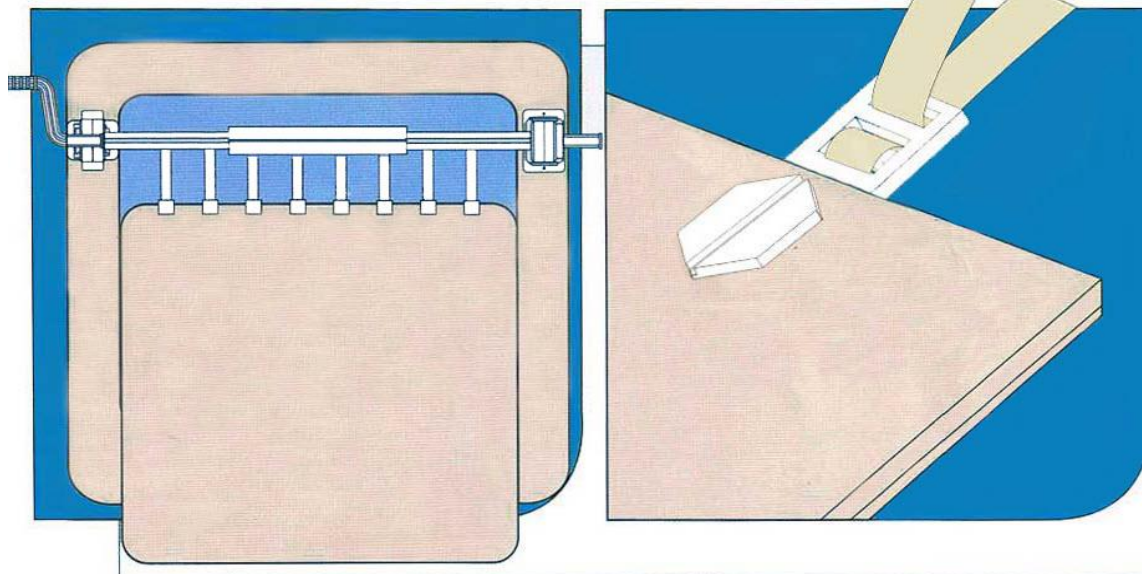

7a

Pierce a hole through the pool blanket using a sharp pointed *object like a Pen or Screwdriver at least 50mm in from the edge of the pool blanket. Attach blanket clip #12 to the cover by pushing screw part through the hole and tighten until it is firmly fastened.

*On reinforced covers, (non bubble type) you may need to use an 8mm wad punch to make the hole through the cover fabric.

How to attach the straps in the middle of a pool cover - 2 methods

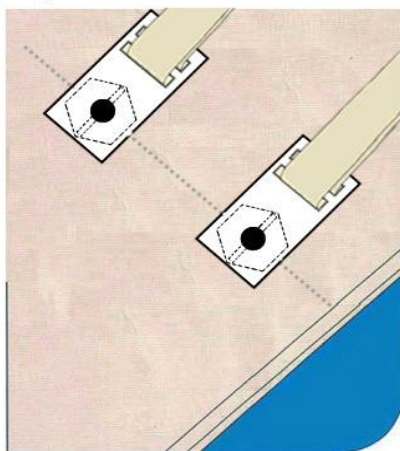
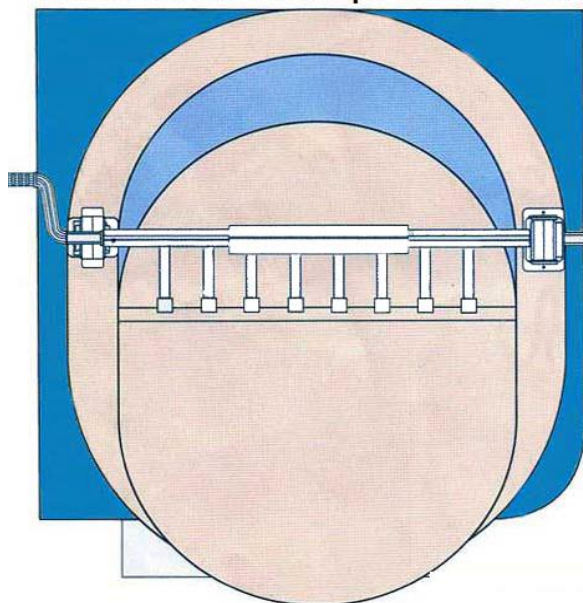

1st method

Fold the cover evenly across the width in line with the position of the Reel and fasten through both layers as shown.

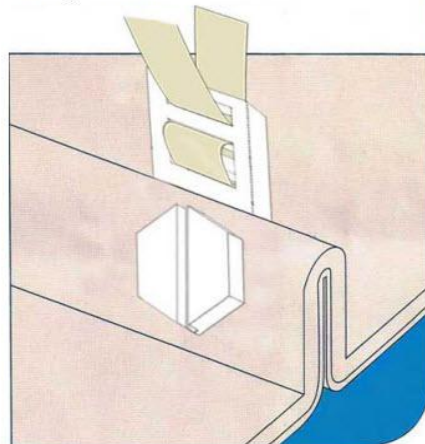

2nd method

Mark a non-permanent line across the width of the cover with tape or chalk in line with the position of the Reel and fasten through a single layer using the screw from the under side of the cover so the strap is on top.

7b

8

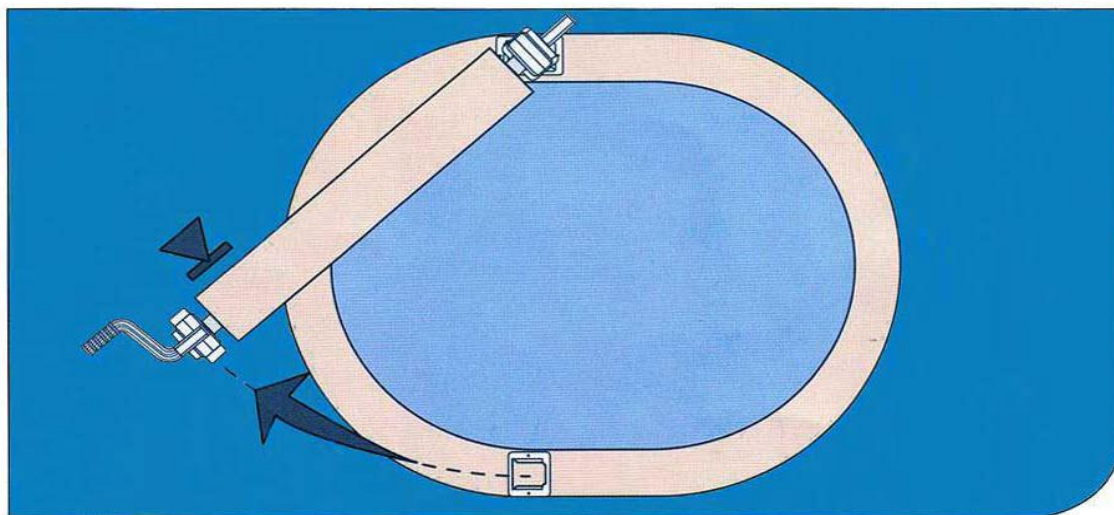

Reel should be removed from the pool by unfastening and lifting from the crank handle end and then pivoting around away from the swimming area or removed completely from the pool.

Warning! - Do not swim unless the cover is completely removed from the surface of the pool. Fully covered or partially covered pools are hazardous for swimming.